

Appendix 18: 'Limekilns & Limeburning in Huish Episcopi & Long Sutton'

Source: Extract supplied by Landowner K

Reference: SIAS Bulletin (unknown issue)

Page 4

Huish Episcopi

Site A - south side of Park Lane (ST 413258).

Three kilns were established here by 1902 and survived until at least 1931. The site has been cleared leaving only an area of rough ground.

Site B - south-east side of Park Lane from Frog Lane junction (ST 414259).

The map evidence is confusing with two kilns in 1886, three in 1902 and two in 1930. It appears that there was an original pair of kilns which faced south. Later another pair were built at right-angles facing east, and one of the original ones abandoned. By 1930 one of each pair was either abandoned or infilled.

None of the bowls can now be examined, all having been infilled. Although the front wall of the original pair of kilns still survive it has not proved possible to examine the arches. The facade of the later pair is however fully visible and is shown in Fig.2. The front and side walls are of lias which is dressed in the double relieving arches with brick as arches over the eyes or grates. There is also a single story building, recently reroofed, adjacent

Page 5

B. PARK LANE (Fig. 2.)

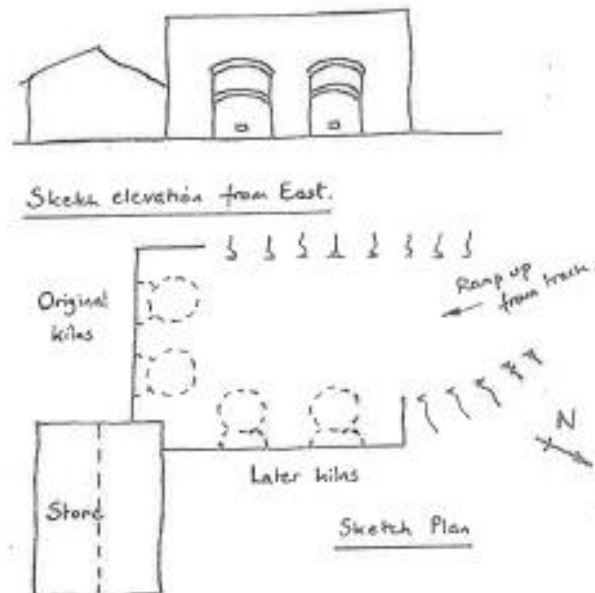

Dimensions

Bowls filled - dia. & construction not known.
Depth 5m approx.

Kilns at Site B can be linked to a nearby quarry (ST 415258) in 1886 and another contemporary quarry functioned on the north side of Park Lane (ST 413259). Extraction at both sites appears to have finished before 1902 but two other quarries were then open; to the south-east of Tucker's Hill (ST413260) and to the west of both kiln sites at Park Quarry (ST 412258). A narrow-gauge tramway, visible as an earthwork, linked the latter quarry to Site A. It is not known when the rails were dismantled but the Tucker's Hill quarry was worked out before 1931. A single storey office building survives in Park Lane (ST413259).

It seems probable that both Sites A and B were operated from late Victorian times to the 1930's by Tom Towing, listed in trade directories as a quarry owner, limeburner and farmer at Merrick's Farm, Park Lane. By 1935 Mead & Sons (Fig.3) had control and in 1931 the complex was known as Park Lane Works. Limeburning may have continued well into the post-war period.

(Fig 3)

STATEMENT

Telegrams : "MEAD, LANGPORT SOM"
Telephones : LANGPORT 306
WORKS AT LANGPORT

LANGPORT.....19.....
SOM.

MEAD & SONS LIME & STONE CO. LTD.

LIME & STONE MERCHANTS

19

FIG.1 LIMEKILNS & QUARRIES IN
LONG SUTTON & HUISH EPISCOPI

△ KILN ○ QUARRY

